

Single specification		
Product Name		Sealed Nickel Metal Hydride Cylindrical Rechargeable Battery
Model		EJH-1/3AA350
Nominal Voltage		1.2V
Nominal Capacity		50mAh
Dimension (with tube)	Diameter	14.5 ⁺⁰ / _{-0.7}
	Height	17.5 ⁺⁰ / _{-1.0}
Internal Resistance at 1000Hz		≤ 40mΩ (After charge)
Charge	Standard	25mA × 16h
	Rapid	125mA × 2.5h
	Trickle	7.5~12.5mA
Discharge Cut-off Voltage		1.0V
Cycle Life		≥ 500 Cycles
Ambient Temperature	Standard Charge	0°C to 45°C
	Rapid Charge	10°C to 40°C
	Trickle Charge	0°C to 45°C
	Discharge	-20°C to 50°C
	Storage	-20°C to 45°C
Ambient Humidity		65±20%

General Characteristics

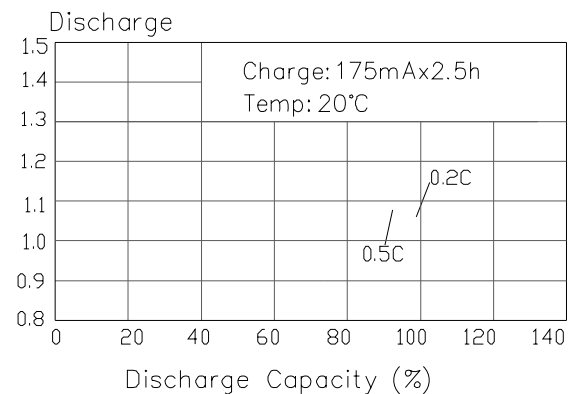
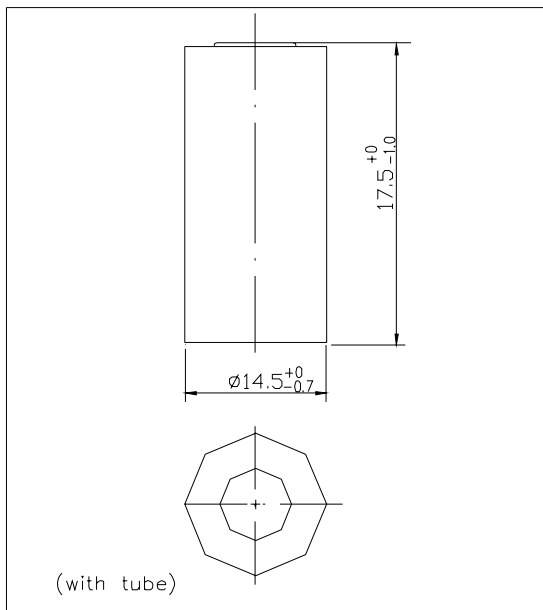
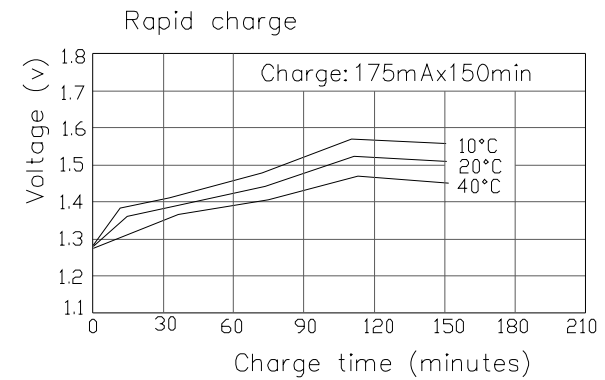
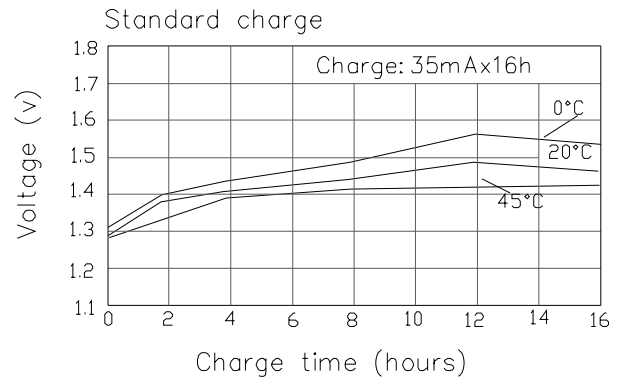

Manufacturer reserves the right to alter or amend the approval sheet without the prior notice